

Logbook

2025-11-01

I started my project. I will use a wind turbine and test different 3D printed wind turbines to see which is the best form.

2025-11-02

I saw a video on how to make a wind turbine-this link right here-and I will make this into a 3d model to 3d print afterwards. I also will 3D print the wind turbines to go on the mode itself.

2025-11-07

I have finished making the wind turbine in Blender™ with the help of my father. :D

2025-11-17

I CHANGED MY PROJECT. It was getting very hard and I would have to model lots of things.

Soo, I'm thinking about other projects to do instead.

2025-12-01

OK, I've been thinking about other projects and I GOT ONE. My basement in my house is always FREEZING- and the upstairs is burning so what if I made a whatchamacallit to bring upstairs warm air to the basement? I did some research and found other people had the SAME PROBLEM. So this could be good! :D

Ok I started my NEW project and it's going well. I did some more research that there are A LOT of people with this problem. It's the same problem at home.

2026-01-03

Today, I'm finding all the things I need for the project such as pipes, a thermometer, a timer, things like that. I already finished my

hypothesis, problem, question and background research. I measured the distance (in cms) of how long from the basement and to the upstairs (my room:]) I will get all the necessities. I have also written down all the measurements in this photo!

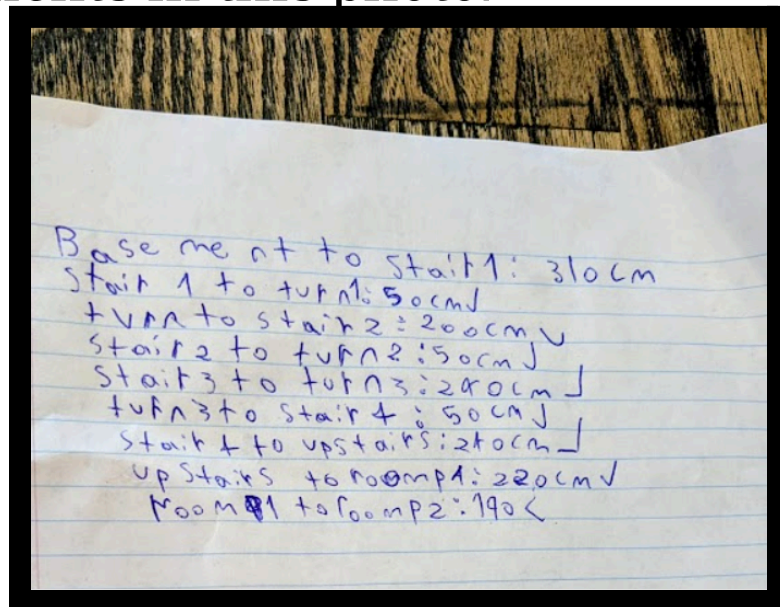

2026-01-10

Today I extended the pipe to the basement and I have tarped my room and the basement door so no air can enter. I also made a 3d printed pipe connector so it connects with the pipes.

2026-01-11

I have listed all materials for the project in the list below:

Materials

GOVEE© SMART THERMO-HYGROMETER

Model:H5075

SKU:B5075001

Power:2xAAA / 3V

(batteries included)

FCC ID:2AQA6-H5075

CTP100 Bathroom Fan

CFM: 100

Sones: 0.8>1 Sone= Soft Breeze

1Unit

N.W.:6.23 lbs

G.W.:7.3 lbs

Dundas Jafine FD310E Flexible Vinyl Duct For Bathroom Vents and Humidifier Units, White, 3-in x 10-ft

Gorilla Utility Duct Tape, Indoor/Outdoor Weather-Resistant Adhesive, Black

ProPainter

EXTRA LARGE DROP CLOTH

9x15 FT

2.7x4.5M

Dundas Jafine EXWTZW Bathroom and Utility Wall Vent Kit, 4-in x 5-ft Flexible Vinyl Duct

2026-01-16

1 test failed because the pipe disconnected from the other so I fixed it with more duct tape.

2026-01-17

I have finished another test for my project. The temperature has been only in between 4 numbers:

Time	Upstairs Temp	Basmen Temp	
11:31AM	19.2°C	17.5°C	
11:51AM	19.1°C	17.5°C	
12:11AM	19.1°C	17.4°C	
12:31PM	19.2°C	17.4°C	

This is also with the heater on and most of it stayed in one temperature.

2026-01-31

I will now use a stronger blower to push the air and it worked! But the battery runs out in 15 minutes so I need to find a solution for that.

2026-02-1

I have decided to use a leaf blower on one end of the pipe to have a stronger air force to push

the air to the basement. This will help to see better results.

2026-02-1

I was correct! The leaf blower made an impact on the results which made the basement warmer. When the furnace, the Bathroom fan and the Leaf blower were all ON, it would be warmer.

2026-02-4

I changed how the tests are being run now. Now it will be with all blowers including the furnace just in a different order.

From the start to the 20 minute mark, the bathroom fan will be OFF while the furnace will be ON.

From the 20 minute mark to the 40 minute mark, both will be on.

From the 40 minute mark to the 60 minute mark, the Bathroom fan will be ON and the furnace will be OFF.